

Making New York City Hurricane Sandy Proof



Presented by Michael Grant, Tony Mizutani, Daniel Smith, David Mashkevich, and Emily Nemecek

History of Hurricanes



Saffir-Simpson Scale

Category	Wind Speed	Pressure (millibars)	Storm Surge	Damage
1	74-95 mph	>979	4-5 feet	minimal
2	96-110 mph	979-965	6-8 feet	moderate
3	111-130 mph	964-945	9-12 feet	extensive
4	131-155 mph	944-920	13-18 feet	extreme
5	>155 mph	<920	>18 feet	catastrophic

Tracking Hurricane Sandy



Hurricane Sandy Damages

- 7.5 million people lost power
- 230+ people died
- Storm surges were 14 ft above the average low tide



Storm Surge Protection

- Hurricane and Storm Risk Reduction System (HSRRS)
- New Orleans, Louisiana



Barrier Islands

- Fire Island, NY



Flood Gates

- Oosterscheldekering
- North Sea
- Netherlands



Flood Protection of Tunnels



INFLATED PLUG, 32 FEET LONG AND 16.2 FEET IN DIAMETER

SUBWAY TUNNEL

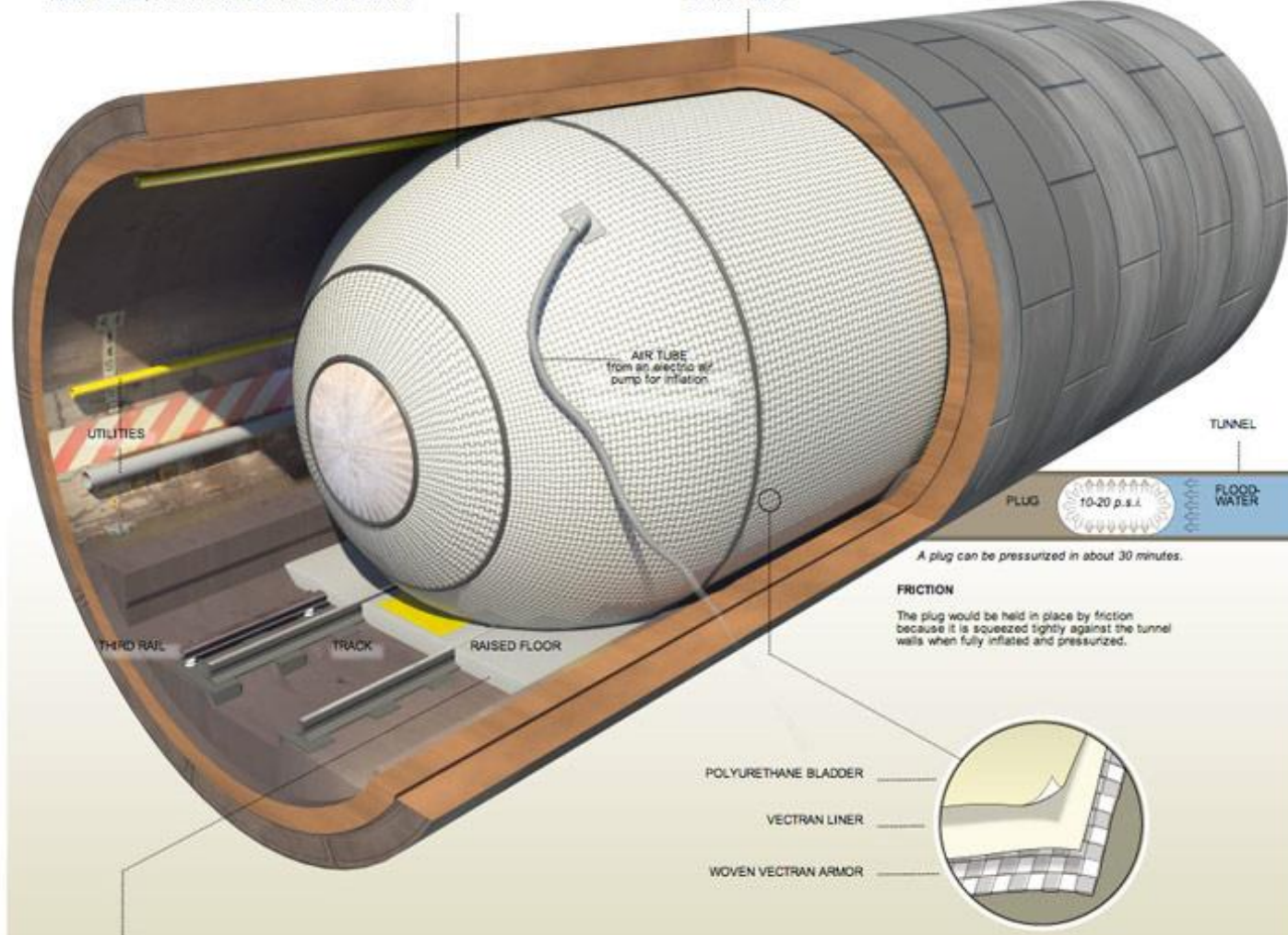

The Big U



Social Infrastructure



BIG BENCH



BATTERY



BERM

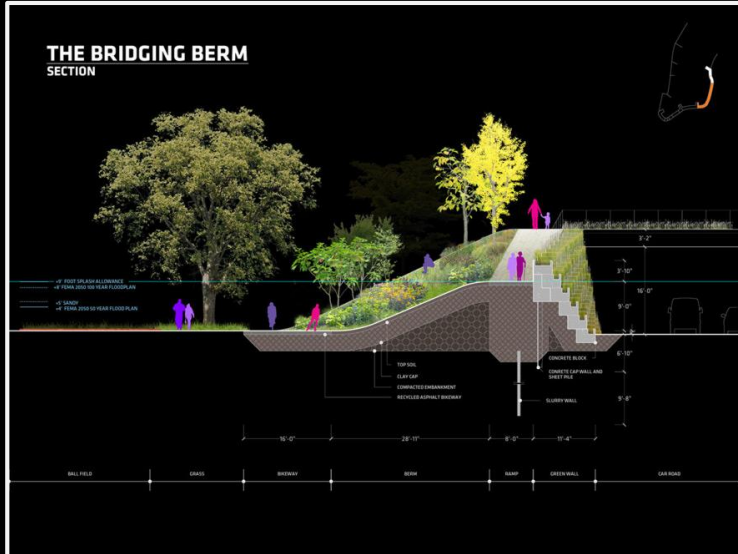
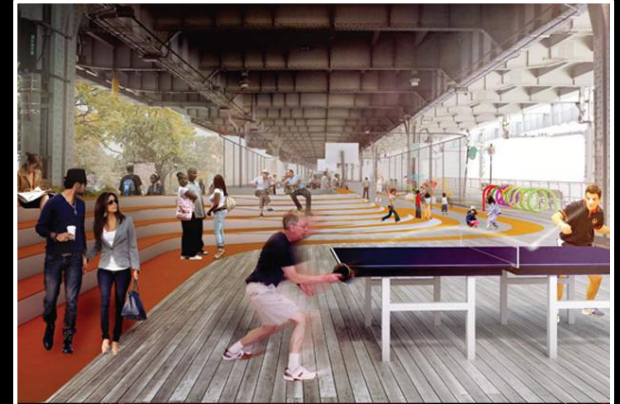

THE BIG "U"

TAILOR-FIT, SOCIAL INFRASTRUCTURE!



RESILIENCY INFRASTRUCTURE

PEOPLE!

RESILIENCY INFRASTRUCTURE

PROGRAM

RESILIENCY INFRASTRUCTURE

COMMUNITY



ROBERT MOSES

JANE JACOBS

Storm Surge Protection Model



Boardwalk Barrier



Emergency Gate-And-Dike System (EGADS)

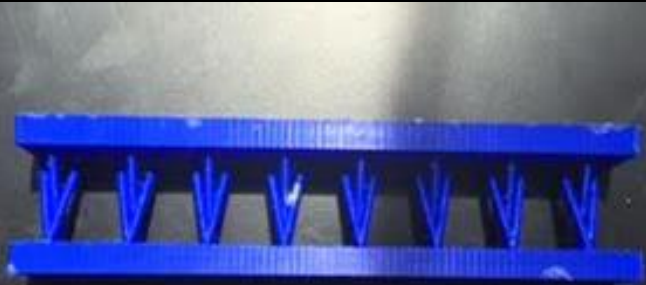
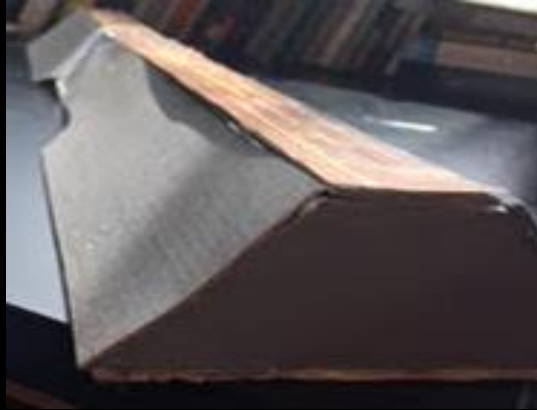

The HELP System



Red Hook Wall and Park

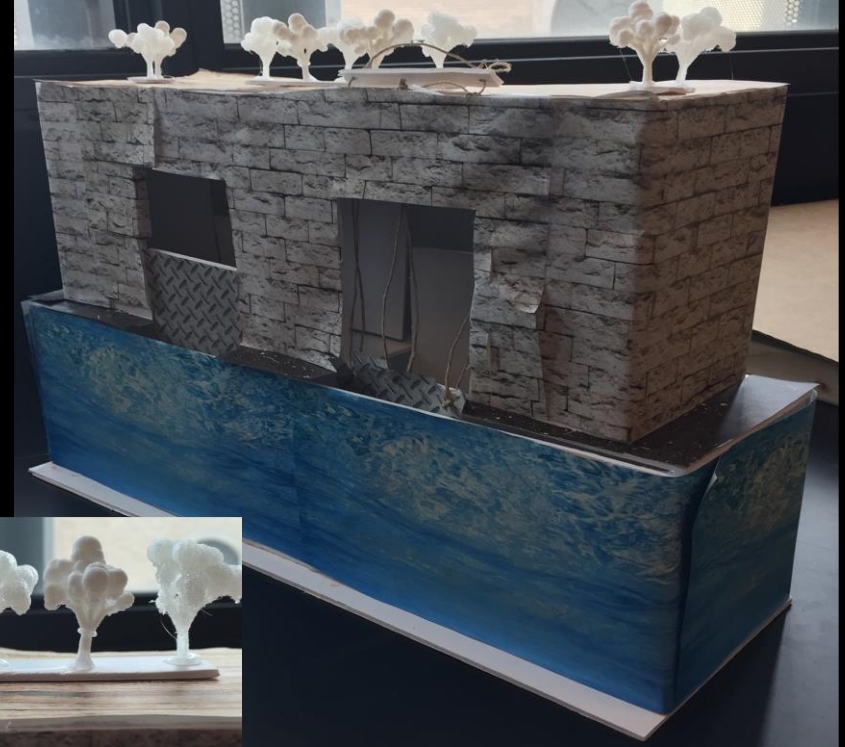
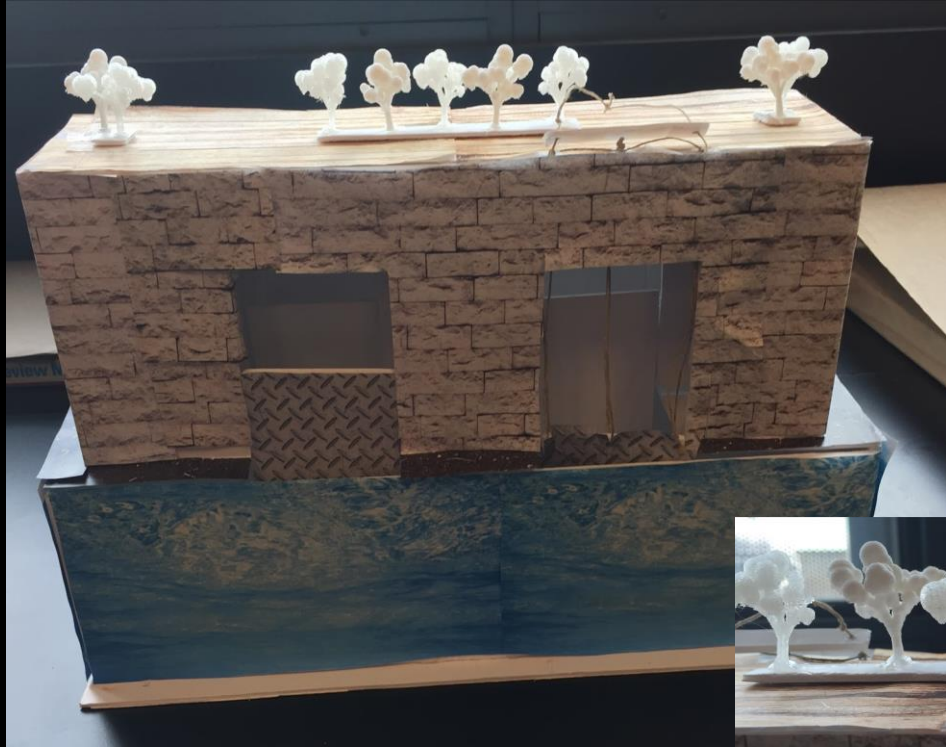

Acknowledgements

- Professor Guido
- Teaching Assistants:
 - Kan Jin Zou
 - Nina Berlow
 - Sambit Acharya
- Victoria Bill

Questions?